

# PRODUCT SPECIFICATION SHEET

## 8kg Commercial Heat Pump Dryer



### PDR908HP

**Dimension:**

W605 x D777 x H850 mm

**Finish:**

Stainless Steel

**Features:**

- Equivalent to 9kg Miele domestic capacity
- 7 star energy rating
- Designed to last 30,000 cycles
- Up to 60% less energy used than conventional dryers
- No venting required
- Dual compliant, can be used in both business & household
- Sensor & timed drying programs
- Laundrette mode option - screen locked for simple use
- Honey comb drum for gentle fabric care & reduced creasing

NOTE: Images, specifications and dimension correct at the time of publishing. It is advised that these details be confirmed prior to construction as no liability will be taken by Harvey Norman Commercial for any changes in specifications.

# PRODUCT SPECIFICATION SHEET

## 8kg Commercial Heat Pump Dryer

**Miele**

**PDR908HP**

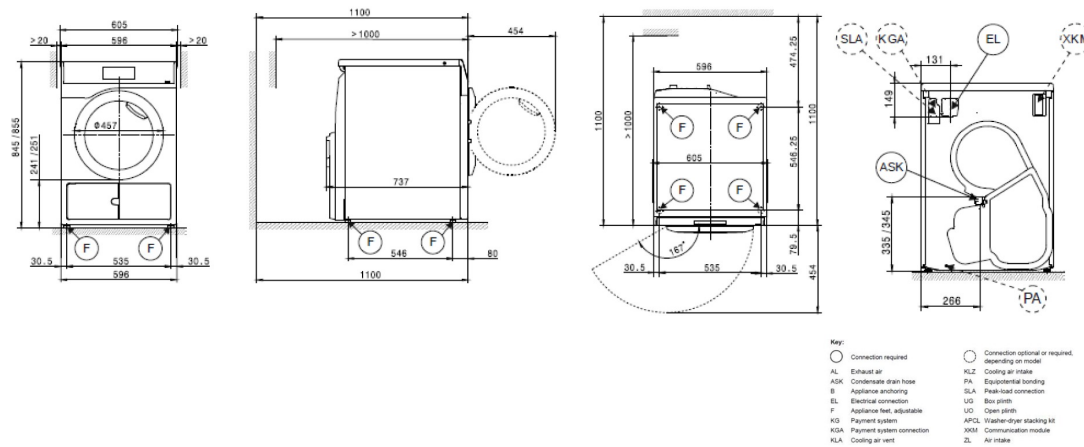

NOTE: Images, specifications and dimension correct at the time of publishing. It is advised that these details be confirmed prior to construction as no liability will be taken by Harvey Norman Commercial for any changes in specifications.