

PRODUCT SPECIFICATION SHEET

600mm Gas Waterless Stockpot



CSP6

Cobra®

Dimension:

W600 x D800 x H1280mm

Finish:

Stainless Steel

Features:

- Cobra suite matching
- 70MJ/hr 18 jet Duckbill burner
- High splashback with shelf
- Pot filling water laundry swivel arm on splashback
- Front waste channel
- Stainless steel spill tray
- Rear waste channel
- Cast iron potstand
- Suits up to 150L stockpot
- Flame failure protection with pilot burner

NOTE: Images, specifications and dimension correct at the time of publishing. It is advised that these details be confirmed prior to construction as no liability will be taken by Harvey Norman Commercial for any changes in specifications.

PRODUCT SPECIFICATION SHEET

600mm Gas Waterless Stockpot

Cobra®

CSP6

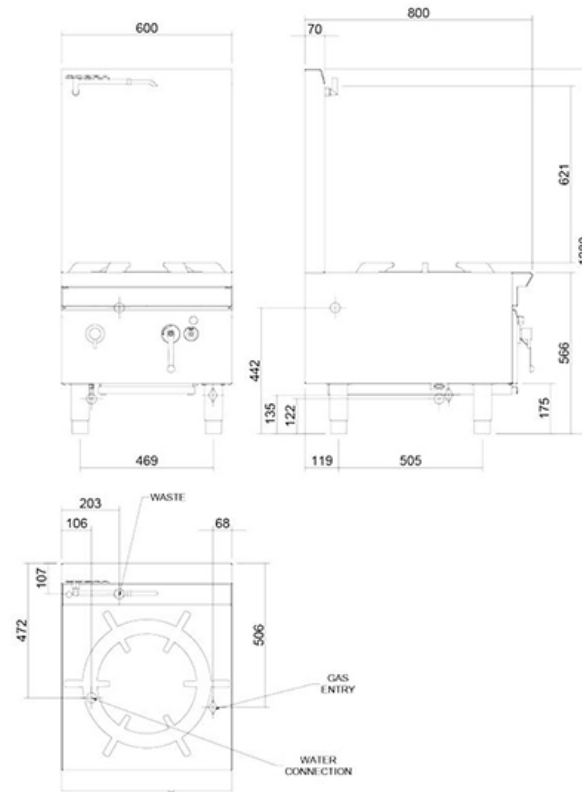

NOTE: Images, specifications and dimension correct at the time of publishing. It is advised that these details be confirmed prior to construction as no liability will be taken by Harvey Norman Commercial for any changes in specifications.